

Tuning Stability Starts Here

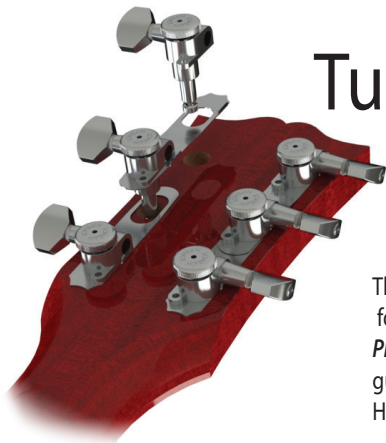

Thank you for choosing the *Hipshot® Tuner Upgrade Kit* for your guitar. The *Hipshot® Universal Mounting Plate™* system makes installation a breeze and keeps your guitar in vintage condition so its value doesn't diminish. Happy playing!



The only tool required is a 10 mm wrench.

10 mm

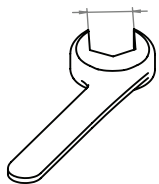

1 Remove your old tuners and bushings. Clean off your headstock with a soft cloth.

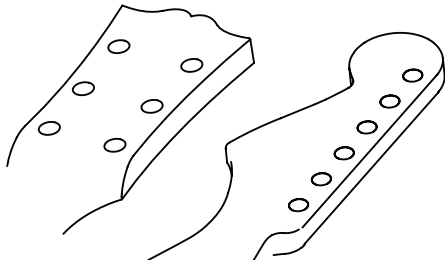

2 Arrange the Universal Mount Plates on your headstock as shown.

Small plates have 1 set of tabs. Place them down first.

Big plates have 2 sets of tabs. Place them over the small plates.

Position the plates so that the tabs are above the holes as shown.

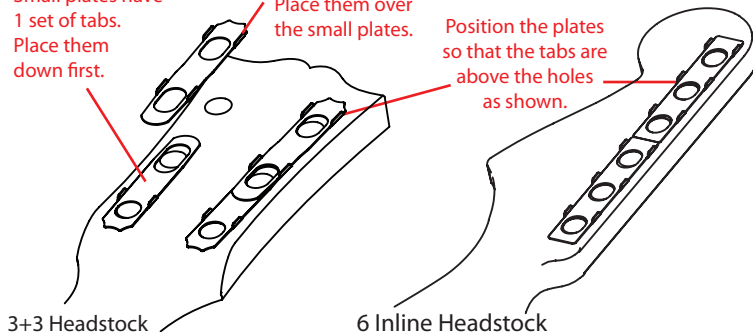

3+3 Headstock

6 Inline Headstock

3 If your kit features staggered string posts, divide your tuners into 3 groups: short, medium, and long. Hold them as shown to measure the length.

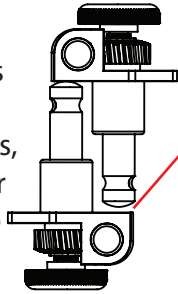

A gap between string post and body means the tuner is shorter.

Typically, 6 inline sets are staggered. 3+3 sets are not.

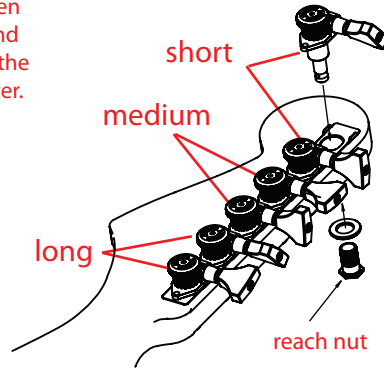

4 Insert the tuner shafts through the plate and headstock holes. Loosely screw the reach nuts with washers from the front.

Don't tighten yet.

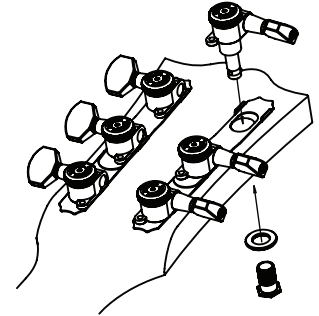

5 With the reach nuts still loose, adjust the final position of the tuners and plates. Make sure the tuners are resting between the tabs and that the plates are straight and attractively arranged. Now carefully tighten the reach nuts.

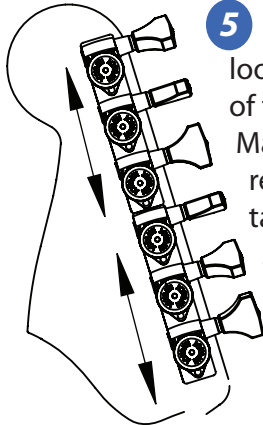

Don't over-tighten.

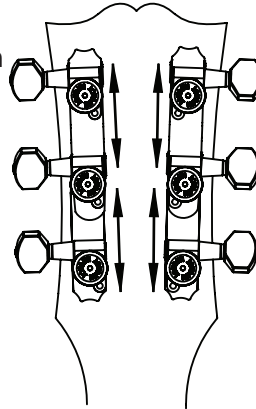

Tuners should be positioned so they are resting against the tabs as shown.

